

RESOLUTION NO. _____

A RESOLUTION OF APPLICATION PROPOSING PROCEEDINGS FOR ANNEXATION OF TERRITORY TO THE CITY OF BAKERSFIELD IDENTIFIED AS ANNEXATION NO. 711, GENERALLY LOCATED NORTH AND SOUTH OF TAFT HIGHWAY, AND EAST OF OLD RIVER ROAD (WARDS 5 AND 7).

WHEREAS, the City of Bakersfield desires to propose a change of organization, to wit, the annexation to the City of Bakersfield of the hereinafter-described territory, pursuant to Section 56654 of the Government Code of the State of California; and

WHEREAS, the proposed annexation territory is within and consistent with the City of Bakersfield Sphere of Influence boundary; and

WHEREAS, the City of Bakersfield agrees to annex the territory generally located north and south of Taft Highway, and east of Old River Road; and

WHEREAS, the City agrees to serve the territory upon annexation; and

NOW, THEREFORE, BE IT RESOLVED by the Council of the City of Bakersfield that it hereby finds and determines as follows:

1. The above recitals, incorporated herein, are true and correct.
2. That the City of Bakersfield hereby proposes the annexation to the City of Bakersfield of the territory in Exhibit A and shown on map marked Exhibit B for the project attached hereto, and made a part of this resolution as though fully set forth herein, generally located north and south of Taft Highway, and east of Old River Road.
3. That a plan for providing services within the affected territory of the proposed annexation, in accordance with the provisions of Section 56653 of the Government Code, is marked as Exhibit C, attached hereto and made a part hereof as though fully set forth herein.
4. That this proposal for change of organization, to wit, annexation, is made pursuant to the Cortese-Knox-Hertzberg Local Government Reorganization Act of 2000, and it is requested that proceedings be authorized for annexation in accordance therewith.
5. That the reasons for the proposed change of organization are that some owners of the affected territory desire to receive municipal services from the City of Bakersfield.
6. That the laws and regulations relating to the preparation of a notice of exemption as set forth in the California Environmental Quality Act have been duly followed.

7. That the territory proposed for annexation as described herein has been determined to be inhabited pursuant to Section 56046 of the Government Code.
8. That the territory proposed for annexation as described herein has been determined not to have 100% property owners consenting to annexation.
9. That the territory proposed for annexation as described herein is within the City of Bakersfield Sphere of Influence boundary.
10. That this proposed annexation territory will be incorporated into Ward 5 and Ward 7 and the boundaries will be adopted by Ordinance within Bakersfield Municipal Code Chapter 1.12 (Wards).
11. That the names of the officers of the City of Bakersfield who are to be furnished with copies of the Executive Officer's Report and who are to be given mailed Notice of Hearing, if any, are:

Julie Drimakis
City Clerk
City of Bakersfield
1600 Truxtun Avenue
Bakersfield, CA 93301

Christian Clegg
City Manager
City of Bakersfield
1600 Truxtun Avenue
Bakersfield, CA 93301

Virginia Gennaro
City Attorney
City of Bakersfield
1600 Truxtun Avenue
Bakersfield, CA 93301

12. That the appropriate City officials shall file the (10) copies of this Resolution, with Exhibits, with the Executive Officer of the Local Agency Formation Commission of Kern County at 5300 Lennox Street, Suite 303, Bakersfield, and CA 93309.

-----o0o-----

I HEREBY CERTIFY that the forgoing Resolution was passed and adopted by the City Council of the City of Bakersfield at a regular meeting thereof held on _____, by the following vote:

AYES:	COUNCILMEMBER: ARIAS, GONZALES, WEIR, SMITH, FREEMAN, GRAY, KAUR
NOES:	COUNCILMEMBER: _____
ABSTAIN:	COUNCILMEMBER: _____
ABSENT:	COUNCILMEMBER: _____

JULIE DRIMAKIS, CMC
CITY CLERK and Ex Officio Clerk
of the Council of the City of Bakersfield

APPROVED

KAREN GOH
MAYOR of the City of Bakersfield

APPROVED as to form:
VIRGINIA GENARO
City Attorney

By: _____
VIRIDIANA GALLARDO-KING
Deputy City Attorney

EXHIBITS: A – Legal Description
 B – Map
 C – Plan for Services

S:\Advance Planning\03_Annexations\03_Active\711 - Taft Hwy No. 4\Res_Ord

EXHIBIT "A"
OLD RIVER No. _____
CITY OF BAKERSFIELD ANNEXATION No. _____
LEGAL DESCRIPTION

BEING ALL THOSE PORTIONS OF SECTIONS 31 AND 32, TOWNSHIP 30 SOUTH, RANGE 27 EAST AND SECTIONS 4, 5 AND 6, TOWNSHIP 31 SOUTH, RANGE 27 EAST, M.D.M., COUNTY OF KERN, STATE OF CALIFORNIA, BEING DESCRIBED AS FOLLOWS:

COMMENCING AT THE NORTHEAST CORNER OF SAID SECTION 4, ALSO BEING THE CENTERLINE INTERSECTION OF TAFT HIGHWAY (STATE ROUTE VI-KER-119) AND ASHE ROAD; THENCE NORTH 89°10'51" WEST, A DISTANCE OF 30.00 FEET; THENCE NORTH 00°49'38" EAST, A DISTANCE OF 30.00 FEET; THENCE NORTH 89°10'22" WEST, A DISTANCE OF 749.51 FEET TO THE POINT OF BEGINNING, SAID POINT BEING ON THE EXISTING CITY OF BAKERSFIELD CORPORATE BOUNDARY PER ANNEXATION No. 576 (ASHE No. 6); THENCE

- 1) SOUTH 00°45'30" WEST, ALONG THE WEST LINE OF SAID ANNEXATION No. 576 AND SAID CORPORATE BOUNDARY, A DISTANCE OF 646.42 FEET; THENCE
- 2) NORTH 89°10'22" WEST, CONTINUING ALONG SAID WEST LINE AND SAID CORPORATE BOUNDARY, A DISTANCE OF 212.00 FEET; THENCE
- 3) SOUTH 00°45'30" WEST, CONTINUING ALONG SAID WEST LINE AND SAID CORPORATE BOUNDARY, A DISTANCE OF 680.48 FEET TO A POINT ON THE EXISTING CITY OF BAKERSFIELD CORPORATE BOUNDARY PER ANNEXATION No. 503; THENCE
- 4) NORTH 89°18'49" WEST, ALONG THE WEST LINE OF SAID ANNEXATION No. 503 AND SAID CORPORATE BOUNDARY, A DISTANCE OF 1,651.90 FEET TO A POINT ON THE NORTH-SOUTH MID-SECTION LINE OF SAID SECTION 4; THENCE
- 5) SOUTH 00°45'01" WEST, CONTINUING ALONG SAID WEST LINE AND SAID CORPORATE BOUNDARY AND SAID NORTH-SOUTH MID-SECTION LINE, A DISTANCE OF 3,952.27 FEET TO THE SOUTHWEST CORNER OF SAID ANNEXATION No. 503 AND SAID CORPORATE BOUNDARY; THENCE LEAVING SAID CORPORATE BOUNDARY
- 6) SOUTH 00°45'01" WEST, A DISTANCE OF 30.00 FEET TO THE SOUTH QUARTER CORNER OF SAID SECTION 4; THENCE
- 7) NORTH 89°17'40" WEST, ALONG THE SOUTH LINE OF THE SOUTHWEST QUARTER OF SAID SECTION 4, A DISTANCE OF 2,642.60 FEET TO THE SOUTHEAST CORNER OF SAID SECTION 5; THENCE
- 8) NORTH 89°32'29" WEST, ALONG THE SOUTH LINE OF THE SOUTHEAST QUARTER OF SAID SECTION 5, A DISTANCE OF 2,642.65 FEET TO THE SOUTH QUARTER CORNER OF SAID SECTION 5 AND A POINT ON THE EAST RIGHT-OF-WAY LINE OF THE SUNSET RAILROAD; THENCE

EXHIBIT "A"
OLD RIVER No. _____
CITY OF BAKERSFIELD ANNEXATION No. _____
LEGAL DESCRIPTION (CONTINUED)

- 9) NORTH 89°33'00" WEST, ALONG THE SOUTH LINE OF THE SOUTHWEST QUARTER OF SAID SECTION 5, A DISTANCE OF 100.00 FEET TO A POINT ON THE WEST RIGHT-OF-WAY LINE OF SAID SUNSET RAILROAD; THENCE
- 10) NORTH 00°44'20" EAST, ALONG SAID WEST RIGHT-OF-WAY LINE, A DISTANCE OF 3,978.72 FEET TO A POINT ON THE SOUTH LINE OF LOT 5 OF SALES MAP No. 2 OF LANDS OF J.B. HAGGIN FILED FOR RECORD MAY 24, 1889 IN THE OFFICE OF THE KERN COUNTY RECORDER; THENCE
- 11) NORTH 89°35'40" WEST, ALONG THE SOUTH LINE OF SAID LOT 5 AND ALONG THE SOUTH LINE OF LOTS 6 AND 7 OF SAID SALES MAP, A DISTANCE OF 1,882.29 FEET TO THE SOUTHWEST CORNER OF SAID LOT 7, ALSO BEING THE SOUTHEAST CORNER OF TRACT No. 2044 RECORDED IN MAP BOOK 14, PAGE 34 IN THE OFFICE OF SAID COUNTY RECORDER; THENCE
- 12) NORTH 00°43'47" EAST, ALONG THE EAST LINE OF SAID TRACT No. 2044 AND ALONG THE EAST LINE OF TRACT No. 1292 RECORDED IN MAP BOOK 5, PAGE 138 OF SAID COUNTY RECORDER, A DISTANCE OF 1,143.53 FEET; THENCE DEPARTING SAID EAST LINE
- 13) SOUTH 89°11'01" EAST, A DISTANCE OF 180.00 FEET; THENCE
- 14) NORTH 00°43'47" EAST, A DISTANCE OF 167.00 FEET TO A POINT ON THE SOUTH RIGHT-OF-WAY LINE OF SAID TAFT HIGHWAY (STATE ROUTE VI-KER-119), SAID POINT BEING 30.00 FEET SOUTH, AS MEASURED AT RIGHT ANGLES TO THE NORTH LINE OF SAID SECTION 5; THENCE
- 15) NORTH 89°11'01" WEST, ALONG SAID SOUTH RIGHT-OF-WAY LINE, A DISTANCE OF 840.82 FEET TO A POINT ON THE EAST LINE OF SAID SECTION 6; THENCE
- 16) NORTH 89°10'04" WEST CONTINUING ALONG SAID SOUTH RIGHT-OF-WAY LINE, A DISTANCE OF 170.31 FEET; THENCE DEPARTING SAID SOUTH RIGHT-OF-WAY LINE
- 17) NORTH 00°26'25" EAST, A DISTANCE OF 60.00 FEET TO A POINT ON THE NORTH RIGHT-OF-WAY LINE OF SAID TAFT HIGHWAY, ALSO BEING THE SOUTHWEST CORNER OF THE PROPERTY DESCRIBED IN THE DEED RECORDED DECEMBER 31, 1968 IN BOOK 4230, PAGE 476 OF OFFICIAL RECORDS; THENCE
- 18) NORTH 00°26'25" EAST, ALONG THE WEST LINE OF SAID PROPERTY, A DISTANCE OF 184.00 FEET; THENCE
- 19) NORTH 89°10'04" WEST, CONTINUING ALONG SAID WEST LINE, A DISTANCE OF 103.47 FEET TO A POINT ON THE CITY OF BAKERSFIELD CORPORATE BOUNDARY PER ANNEXATION No. 498 (OLD RIVER No. 3); THENCE

EXHIBIT "A"
OLD RIVER No. _____
CITY OF BAKERSFIELD ANNEXATION No. _____
LEGAL DESCRIPTION (CONTINUED)

- 20) NORTH 00°27'04" EAST, ALONG SAID CORPORATE BOUNDARY, A DISTANCE OF 286.57 FEET; THENCE
- 21) SOUTH 89°02'21" EAST, CONTINUING ALONG SAID CORPORATE BOUNDARY, A DISTANCE OF 244.01 FEET TO A POINT ON THE WEST RIGHT-OF-WAY LINE OF OLD RIVER ROAD; THENCE
- 22) SOUTH 00°27'19" WEST, CONTINUING ALONG SAID CORPORATE BOUNDARY AND SAID WEST RIGHT-OF-WAY LINE, A DISTANCE OF 470.02 FEET TO A POINT ON SAID NORTH RIGHT-OF-WAY LINE OF TAFT HIGHWAY (STATE ROUTE VI-KER-119); THENCE
- 23) SOUTH 89°10'32" EAST, CONTINUING ALONG SAID CORPORATE BOUNDARY AND ALONG SAID NORTH RIGHT-OF-WAY LINE, A DISTANCE OF 60.04 FEET TO THE EAST RIGHT-OF-WAY LINE OF SAID OLD RIVER ROAD; THENCE
- 24) NORTH 00°27'01" EAST, CONTINUING ALONG SAID CORPORATE BOUNDARY AND SAID EAST RIGHT-OF-WAY LINE, A DISTANCE OF 2,610.26 FEET; THENCE
- 25) NORTH 00°27'41" EAST, CONTINUING ALONG SAID CORPORATE BOUNDARY AND SAID EAST RIGHT-OF-WAY LINE, A DISTANCE OF 2,610.59 FEET TO A POINT ON THE SOUTH RIGHT-OF-WAY LINE OF McCUTCHEN ROAD AND THE CITY OF BAKERSFIELD CORPORATE BOUNDARY PER ANNEXATION No. 549 (McCUTCHEN No. 8); THENCE
- 26) SOUTH 89°15'28" EAST, ALONG SAID SOUTH RIGHT-OF-WAY LINE OF McCUTCHEN ROAD AND SAID CORPORATE BOUNDARY, A DISTANCE OF 1,286.62 FEET TO THE CITY OF BAKERSFIELD CORPORATE BOUNDARY PER ANNEXATION No. 468 (McCUTCHEN No. 3); THENCE
- 27) SOUTH 89°20'02" EAST, CONTINUING ALONG SAID SOUTH RIGHT-OF-WAY LINE AND SAID CORPORATE BOUNDARY, A DISTANCE OF 1,221.14 FEET TO A POINT ON THE WEST RIGHT-OF-WAY LINE OF SAID SUNSET RAILROAD; THENCE
- 28) SOUTH 00°24'05" WEST, ALONG SAID WEST RIGHT-OF-WAY LINE AND SAID CORPORATE BOUNDARY, A DISTANCE OF 2,613.36 FEET TO THE SOUTHWEST CORNER OF SAID ANNEXATION No. 468 (McCUTCHEN No. 3); THENCE
- 29) SOUTH 89°13'52" EAST, ALONG THE SOUTH LINE OF SAID CORPORATE BOUNDARY, A DISTANCE OF 100.70 FEET TO THE CITY OF BAKERSFIELD CORPORATE BOUNDARY PER ANNEXATION No. 527 (GOSFORD No. 1) ALSO BEING THE CENTER OF SAID SECTION 32; THENCE
- 30) SOUTH 00°24'22" WEST, ALONG THE NORTH-SOUTH MID-SECTION LINE OF SAID SECTION 32 AND THE WEST LINES OF THE CITY OF BAKERSFIELD CORPORATE BOUNDARIES OF ANNEXATIONS No. 527, 530 AND 602, A DISTANCE OF 2,612.47 FEET TO A POINT ON THE NORTH RIGHT-OF-WAY LINE OF SAID TAFT HIGHWAY

EXHIBIT "A"
OLD RIVER No. _____
CITY OF BAKERSFIELD ANNEXATION No. _____
LEGAL DESCRIPTION (CONTINUED)

(STATE ROUTE VI-KER-119) BEING THE NORTH LINE OF THE SOUTH 30 FEET OF SAID SECTION 32; THENCE

- 31) SOUTH 89°11'01" EAST, ALONG THE SAID NORTH LINE OF THE SOUTH 30 FEET OF SECTION 32 AND THE SOUTH LINES OF THE CITY OF BAKERSFIELD CORPORATE BOUNDARIES OF ANNEXATIONS No. 602 AND 530, A DISTANCE OF 2,613.48 FEET TO THE NORTHWEST CORNER OF THE CITY OF BAKERSFIELD CORPORATE BOUNDARY PER ANNEXATION No. 575 (GOSFORD No. 4); THENCE
- 32) SOUTH 00°45'26" WEST, ALONG SAID CORPORATE BOUNDARY ALSO BEING THE WEST RIGHT-OF-WAY LINE OF GOSFORD ROAD, A DISTANCE OF 1,337.52 FEET TO THE SOUTHWEST CORNER OF SAID ANNEXATION No. 575 (GOSFORD No. 4); THENCE
- 33) SOUTH 89°18'57" EAST, ALONG THE SOUTH LINE OF SAID ANNEXATION No. 575 (GOSFORD No. 4), A DISTANCE OF 690.89 FEET TO THE SOUTHEAST CORNER OF SAID ANNEXATION No. 575 (GOSFORD No. 4); THENCE
- 34) NORTH 00°45'19" EAST, ALONG THE EAST LINE OF SAID ANNEXATION No. 575 (GOSFORD No. 4), A DISTANCE OF 1,335.86 FEET TO THE NORTHEAST CORNER OF SAID ANNEXATION No. 575 (GOSFORD No. 4) AND A POINT ON THE NORTH LINE OF THE SOUTH 30 FEET OF SAID SECTION 33; THENCE
- 35) SOUTH 89°10'45" EAST ALONG SAID NORTH LINE AND THE SOUTH LINE OF THE CITY OF BAKERSFIELD CORPORATE BOUNDARY PER ANNEXATION No. 333 (ASHE No. 1), A DISTANCE OF 1,982.35 FEET; THENCE
- 36) SOUTH 89°10'17" EAST, CONTINUING ALONG SAID CORPORATE BOUNDARY, A DISTANCE OF 1,863.85 FEET TO THE POINT OF BEGINNING.

CONTAINING 1,058.92 ACRES, MORE OR LESS.



661-834-4814 • 661-834-0972
2001 Wheelan Court • Bakersfield, CA 93309

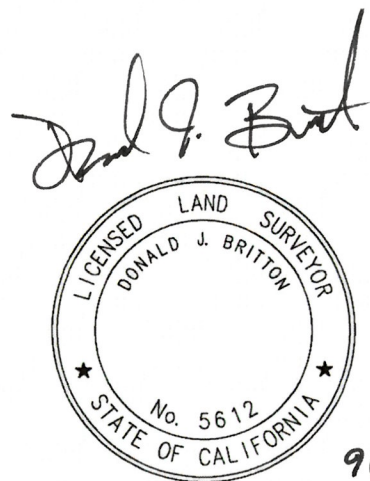

9/29/22

SEC. 31 AND 32 OF T.30S., R.27E. AND
SEC. 4 AND 5 OF T.31S., R.27E., M.D.M.

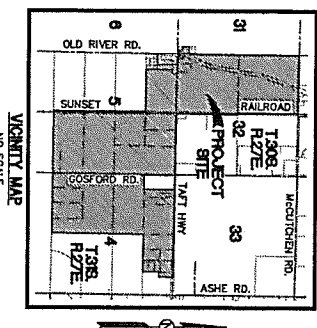

LEGEND:

PROPOSED ANNEXATION BOUNDARY

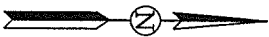
 PROPOSED ANNEXATION AREA

SHEET
1

OF 1 SHEETS

SEC. 31 AND 32 OF T.308, R.27E. AND SEC. 4 AND 6 OF T.318, R.27E., M.D.M.
PROPOSED ANNEXATION EXHIBIT

AriaCAD FILE: 2201REM02_PROP ANNEXATION

[illegible]

2001 WHEELAN COURT
BAKERSFIELD, CALIFORNIA 93309
(661) 834 - 4814

DRIVEN BY: MYW	JOB NO: 22-019
ISSUED FOR: -	DATE: 5/26/22

McINTOSH
& ASSOCIATES
LAND SURVEYING • CIVIL ENGINEERING © 2022



PLAN FOR PROVIDING SERVICES

<u>SERVICE</u> Only provide information on services authorized for applying district.	<u>CURRENT PROVIDER</u> Agency Which Presently Provides Services	<u>BEGIN DATE</u> City/District Will Provide Services		<u>FINANCED</u> Indicate How Services Provided by City/District will be Financed (i e , general tax rate or special assessment
		Upon Annexation	Future Date (Specify)	

Please provide the following information, when applicable, only for services which will be provided by the applicant City/District.

<u>SERVICE</u>	<u>LOCATION</u> Indicate location from which service will be provided (i.e., nearest fire station, library, etc.)	<u>SERVICE LEVEL CAPACITY</u> Indicate frequency and availability of service (i.e. street sweeping, emergency services response time, recreation programs, etc.)